



**BOOSALIS**  
PROPERTIES

REAL ESTATE INVESTMENT AND MANAGEMENT

## HEAVY INDUSTRIAL WAREHOUSE FOR LEASE 1051-A CANNONS CT. WOODBRIDGE, VA 22191



### PROPERTY OVERVIEW

Available Unit:	Suite A-B
Available SF:	3,240 - 6,120 SF
Lease Price:	\$15.00/PSF NNN
Parking:	6 - 12 designated spaces
Zoning:	M-1 (Heavy Industrial)
Drive-In:	One or two 12' x 12' bay doors
Ceiling Height:	16' clear
Mezzanine:	650 - 1,350 SF of additional storage

### AREA HIGHLIGHTS

This heavy industrial park is located in North Woodbridge with quick and easy access to Route 1, Route 123 and I-95. Located in Prince William County but just across the Occoquan Bridge from Fairfax County.

The surrounding area consists of additional flex spaces, industrial warehouses, the O.W.L. Volunteer Fire Department, and a new 100,000 sf distribution center.

Population:	3 miles	69,750
	5 miles	182,706
	10 miles	551,418

### FOR MORE INFORMATION

#### GEORGE BOOSALIS

President/Principal Broker  
george@boosalisproperties.com  
703.494.7691 office | 703.283.6071 cell

#### MELANIE NOBRIGA

melanie@boosalisproperties.com  
703.494.7691 office | 808.937.9417 cell

#### THOMAS VELTSISTAS

thomas@boosalisproperties.com  
703.628.8978 cell

**BOOSALIS PROPERTIES** | 13562 Richmond Highway, Suite 100 | Woodbridge, VA 22191 | [www.BoosalisProperties.com](http://www.BoosalisProperties.com)

This information has been obtained through sources deemed reliable, but accuracy can not be guaranteed.



**BOOSALIS**  
PROPERTIES

REAL ESTATE INVESTMENT AND MANAGEMENT

## HEAVY INDUSTRIAL WAREHOUSE FOR LEASE 1051-A CANNONS CT. WOODBRIDGE, VA 22191



### FOR MORE INFORMATION

**GEORGE BOOSALIS**

President/Principal Broker

[george@boosalisproperties.com](mailto:george@boosalisproperties.com)

703.494.7691 office | 703.283.6071 cell

**MELANIE NOBRIGA**

[melanie@boosalisproperties.com](mailto:melanie@boosalisproperties.com)

703.494.7691 office | 808.937.9417 cell

**THOMAS VELTSISTAS**

[thomas@boosalisproperties.com](mailto:thomas@boosalisproperties.com)

703.628.8978 cell

**BOOSALIS PROPERTIES** | 13562 Richmond Highway, Suite 100 | Woodbridge, VA 22191 | [www.BoosalisProperties.com](http://www.BoosalisProperties.com)

This information has been obtained through sources deemed reliable, but accuracy can not be guaranteed.



**BOOSALIS**  
PROPERTIES

REAL ESTATE INVESTMENT AND MANAGEMENT

## HEAVY INDUSTRIAL WAREHOUSE FOR LEASE 1051-A CANNONS CT. WOODBRIDGE, VA 22191

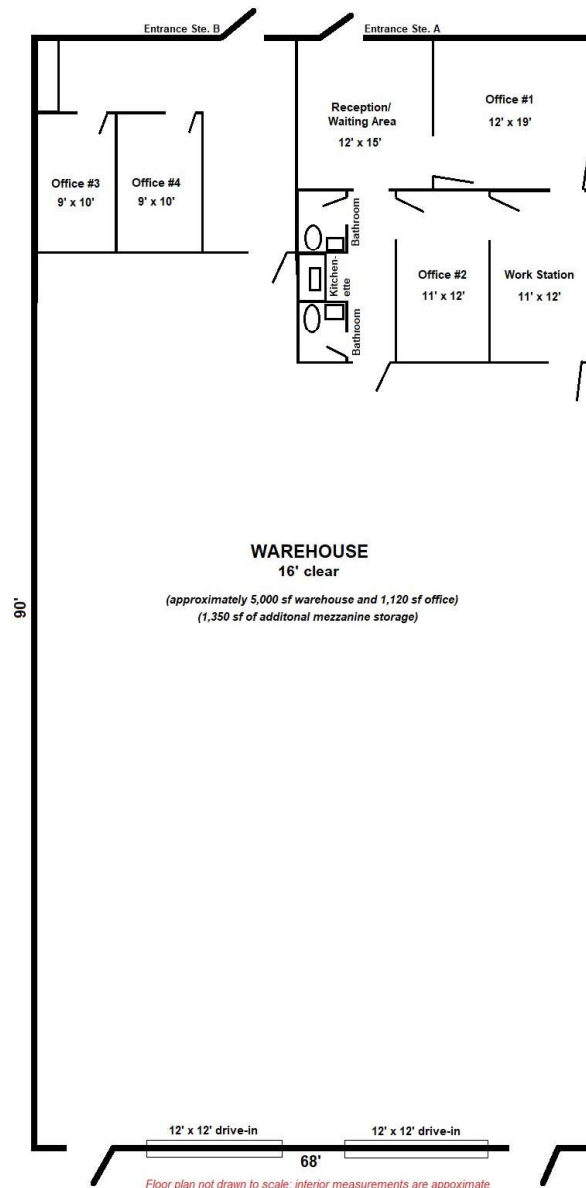

### FOR MORE INFORMATION

**GEORGE BOOSALIS**

President/Principal Broker

george@boosalisproperties.com

703.494.7691 office | 703.283.6071 cell

**MELANIE NOBRIGA**

melanie@boosalisproperties.com

703.494.7691 office | 808.937.9417 cell

**THOMAS VELTSISTAS**

thomas@boosalisproperties.com

703.628.8978 cell

**BOOSALIS PROPERTIES** | 13562 Richmond Highway, Suite 100 | Woodbridge, VA 22191 | [www.BoosalisProperties.com](http://www.BoosalisProperties.com)

This information has been obtained through sources deemed reliable, but accuracy can not be guaranteed.



**BOOSALIS**  
PROPERTIES

REAL ESTATE INVESTMENT AND MANAGEMENT

## HEAVY INDUSTRIAL WAREHOUSE FOR LEASE 1051-A CANNONS CT. WOODBRIDGE, VA 22191

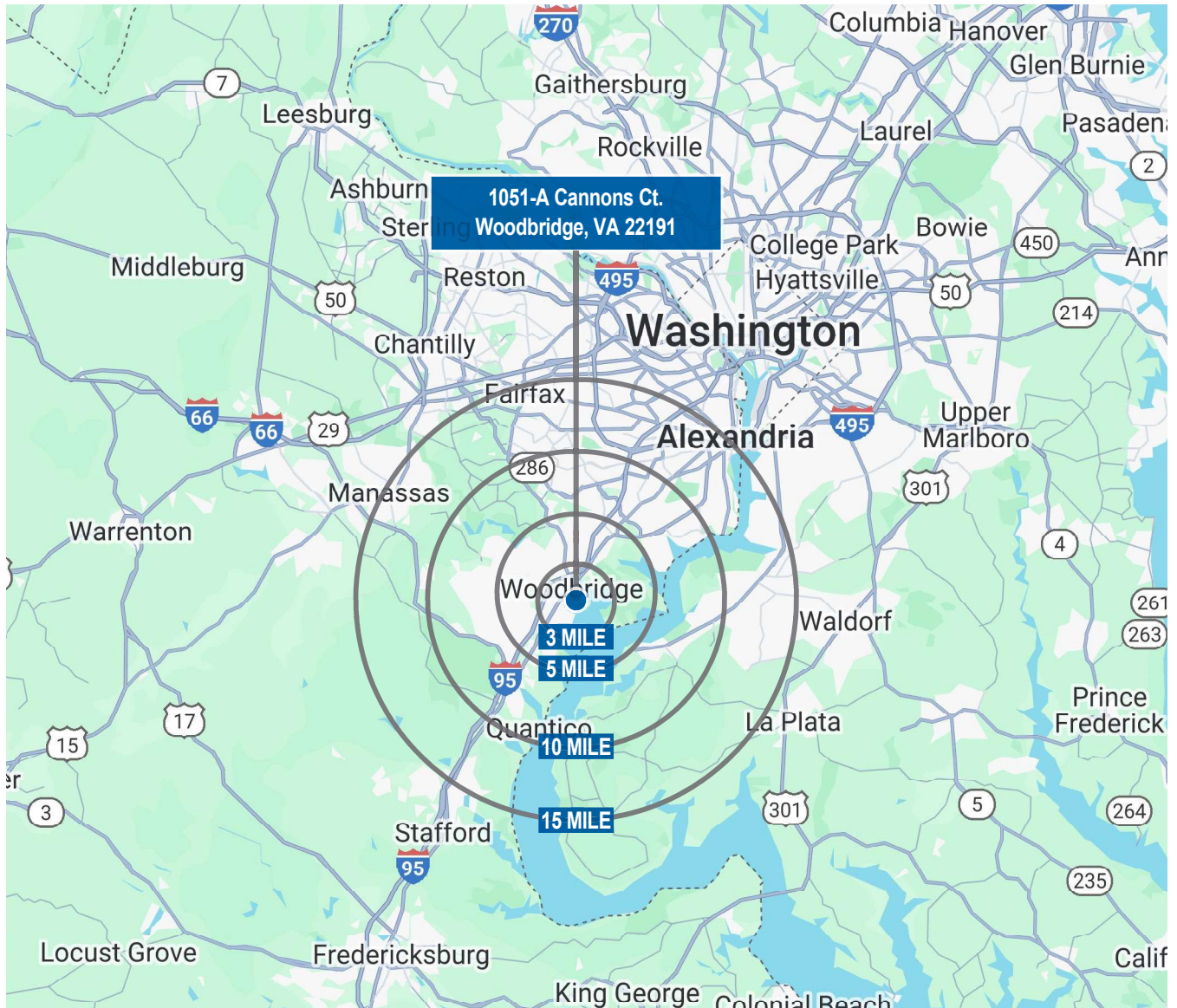

### FOR MORE INFORMATION

**GEORGE BOOSALIS**

President/Principal Broker

george@boosalisproperties.com

703.494.7691 office | 703.283.6071 cell

**MELANIE NOBRIGA**

melanie@boosalisproperties.com

703.494.7691 office | 808.937.9417 cell

**THOMAS VELTSISTAS**

thomas@boosalisproperties.com

703.628.8978 cell

**BOOSALIS PROPERTIES** | 13562 Richmond Highway, Suite 100 | Woodbridge, VA 22191 | [www.BoosalisProperties.com](http://www.BoosalisProperties.com)

This information has been obtained through sources deemed reliable, but accuracy can not be guaranteed.